

© BRITMET LIGHTWEIGHT ROOFING LTD. All rights reserved.
 This drawing is the property of BRITMET LIGHTWEIGHT ROOFING LTD and Copyright is reserved by them.
 This drawing is issued on the condition that it is not reproduced without the written consent of BRITMET LIGHTWEIGHT ROOFING LTD. Action will be taken against unauthorised use.
 Do not scale off this drawing. All dimensions are in Millimetres U.K.D and to be verified and confirmed on site prior to work commencing.
 All levels shown are in metres U.K.D. This drawing is to be read in conjunction with all relevant Architects and Engineers Drawings and Specifications. Engineers generally referred, e.g. Structural, Mechanical & Electrical.
 All structural works are to be detailed or confirmed and approved by Structural Engineer, including all setting out requirements U.K.D.
 Any discrepancies, errors or omissions to be reported to the BRITMET LIGHTWEIGHT ROOFING LTD for further instructions before commencement of work.

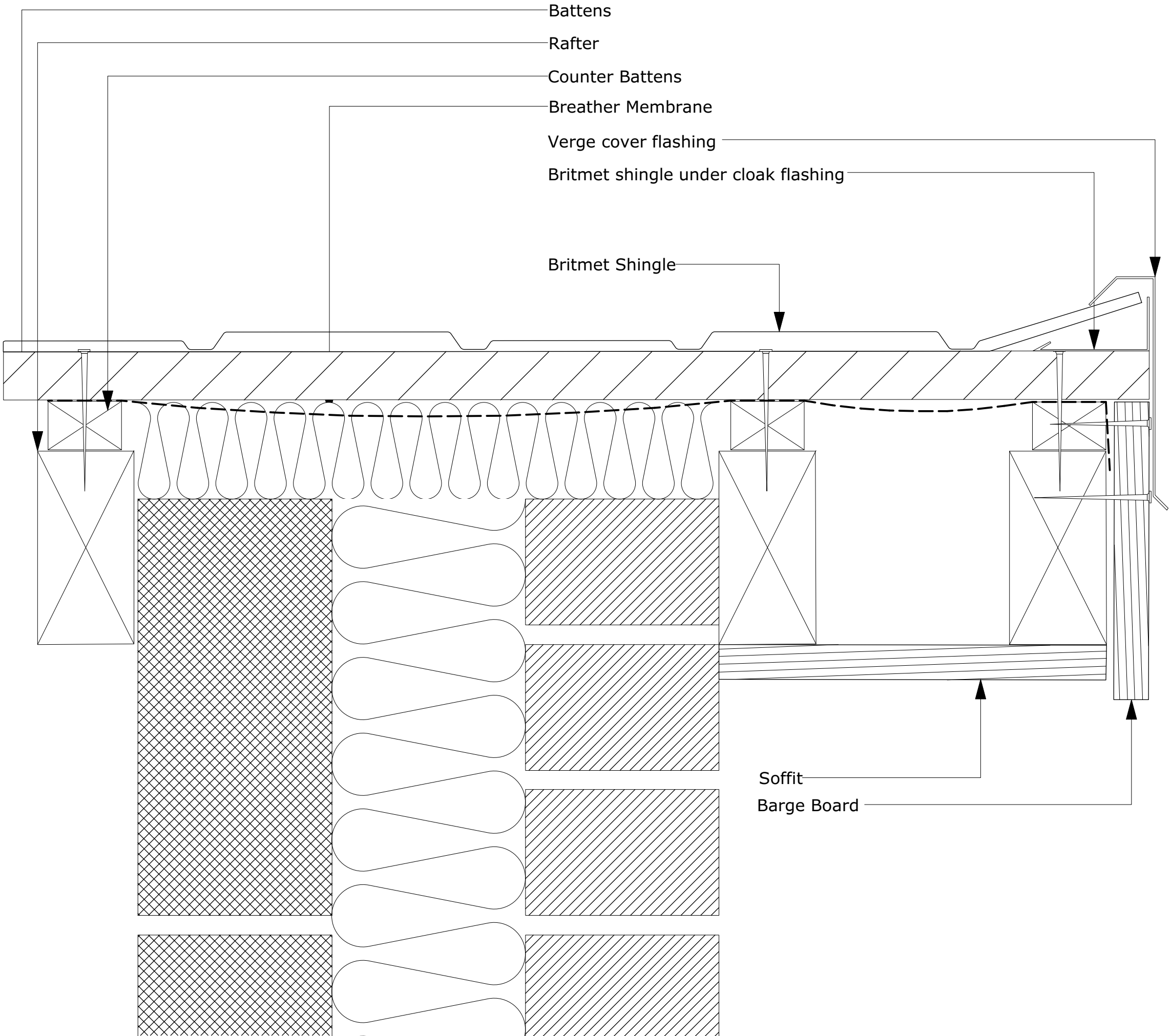

Battens
 Rafter
 Counter Battens
 Breather Membrane
 Verge cover flashing
 Britmet shingle under cloak flashing
 Britmet Shingle

Soffit
 Barge Board

GENERAL NOTES

NO.	DATE	DESCRIPTION

REVISION HISTORY

ZONE	REV	DESCRIPTION	DATE
BLR	1	Add revision note here	??/??/19

Client
 ADD HERE

BRITMET
 LIGHTWEIGHT ROOFING

Consultant Details
 Britmet Tileform LTD
 Kingfisher House, Unit 17
 Overthorpe Road, Banbury, OX16 4SX
 TEL: (01295) 250 998
 WEB: www.britmet.co.uk

Project Title
 ADD HERE

Drawing Title
 Britmet Shingle
 Verge Detail

Drawing Status Illustrative	Drawing Number BLR-CAD-SHINGLE-0004
Drawn By AC	Revision P01
Checked By -	Consultant Project Number BLR
Date of First Issue 2019	Scale 1:2
CAD File Name	Sheet No. 1 of 1

NB: All fixings to be Galvanised