

1. Non air permeable roof finish such as synthetic slates or profiled metal sheets.
2. Slate / tile battens.
3. 25mm Air gap.
4. 50 x 25mm Secondary counterbatten fixed at 600mm cr/s.
5. Breather membrane < 0.25 MNS/g
6. 50 x 100mm Overall depth counterbatten (50 + 50mm) fixed at 600mm cr/s.
7. 200mm thk insulation (2 x 100mm compressed to 190mm).
8. Lambda 0.037 W/mk.
9. TacTray 90 - 0.75 / 1.00mm gauge.
10. Side flange stitcher screws @ 600mm cr/s.
11. Factory fitted vapour seal.

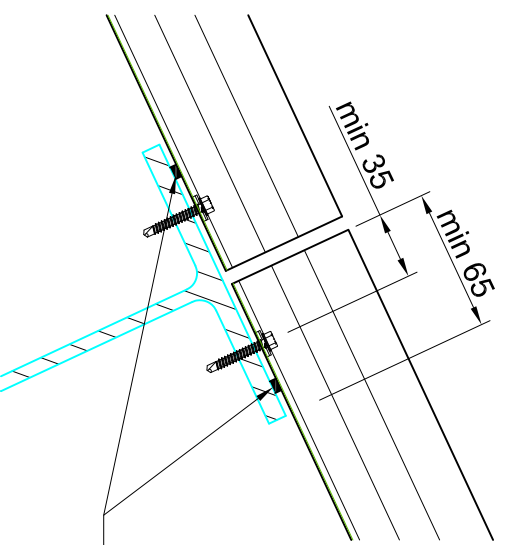

10mm dia butyl bead at end butt joint detail

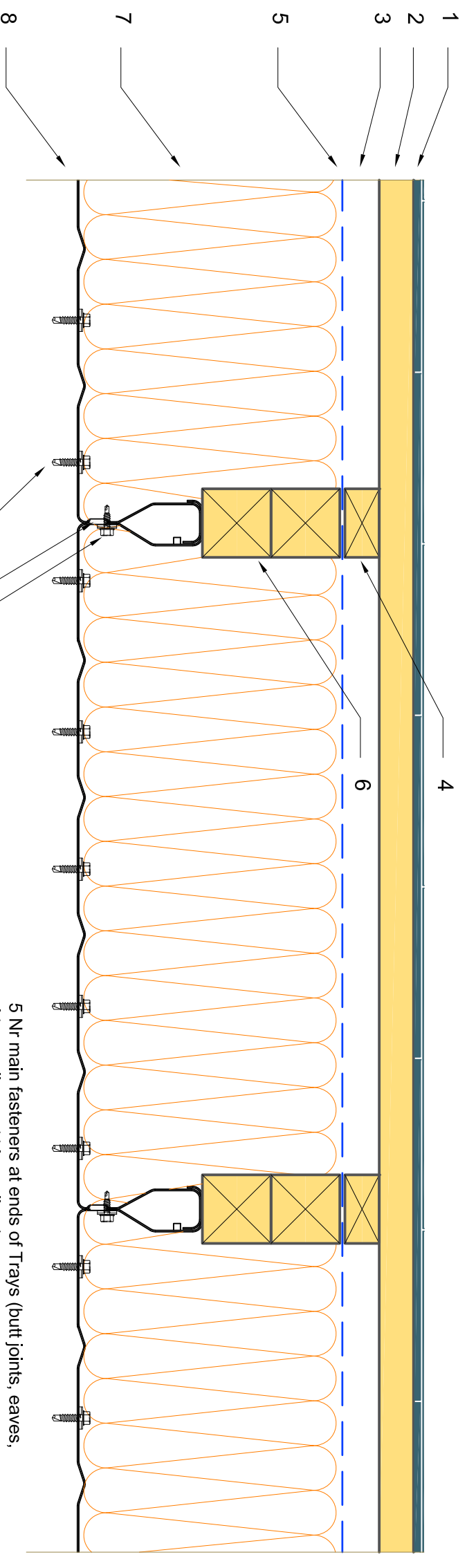

5 Nr main fasteners at ends of Trays (butt joints, eaves, ridge, valley and hip purlins / supports)

3 Nr main fasteners at intermediate positions only

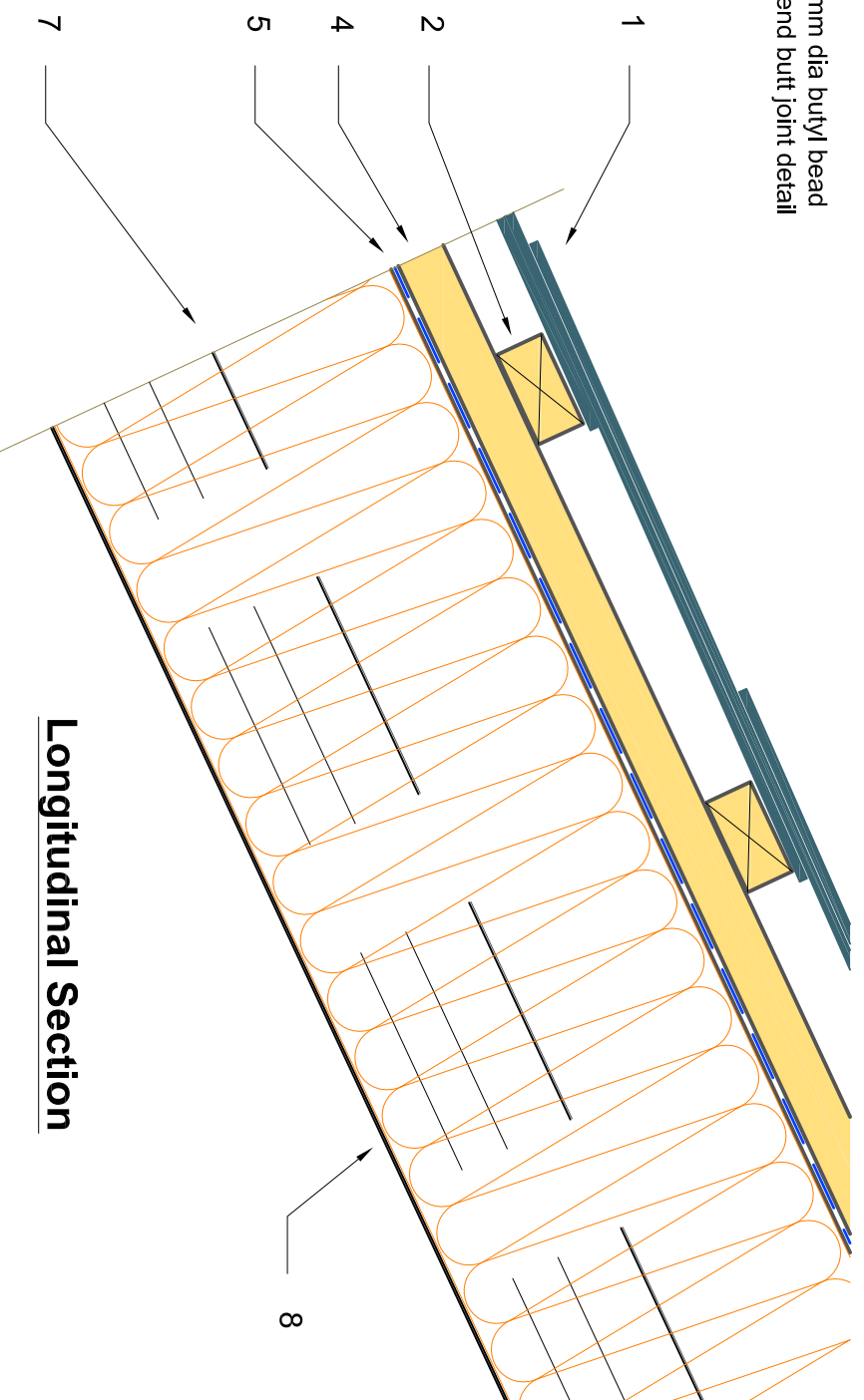

Tileform UK  
TacTray 90

Tileform UK Limited  
Spital Farm Offices  
Thorpe Mead  
Banbury  
Oxon  
OX16 4RZ

Tel: 01295 250998  
Fax: 01295 271068  
email: [britnetileform@hotmail.com](mailto:britnetileform@hotmail.com)  
[www.tileform.co.uk](http://www.tileform.co.uk)

Drawn	Date	Scale
BTD	24/05/09	Do Not Scale

Revisions

Tileform UK TacTray 90 - Standard Construction Details for Non Air Permeable Roof Finishes.  
**U Value 0.18 W/m<sup>2</sup>K.**

DRG No. **TF/TT90/102**