

1. Non air permeable roof finish such as synthetic slates or profiled metal sheets.
2. Slate / tile battens.
3. 50mm Air gap.
4. 50 x 50mm Secondary counterbatten fixed at 600mm cr/s.
5. Breather membrane < 0.25 MNs/g. 50mm thk tissue faced PIR boards.
6. Lambda 0.022 W/mK.
7. 50 x 50mm Counterbatten fixed at 600mm cr/s.
8. 140mm TacMat Plus (lambda 0.037 W/mK).
9. TacTray 90 - 0.75 / 1.00mm gauge.
10. Side flange stitcher screws @ 600mm cr/s.
11. Factory fitted vapour seal.
12. Main fasteners.

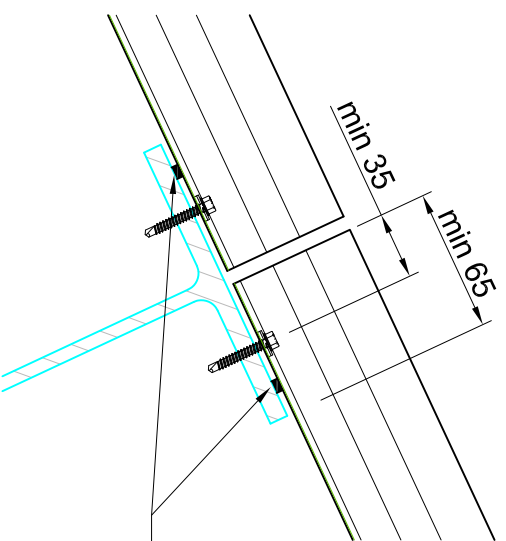

10mm dia butyl bead at end but joint detail

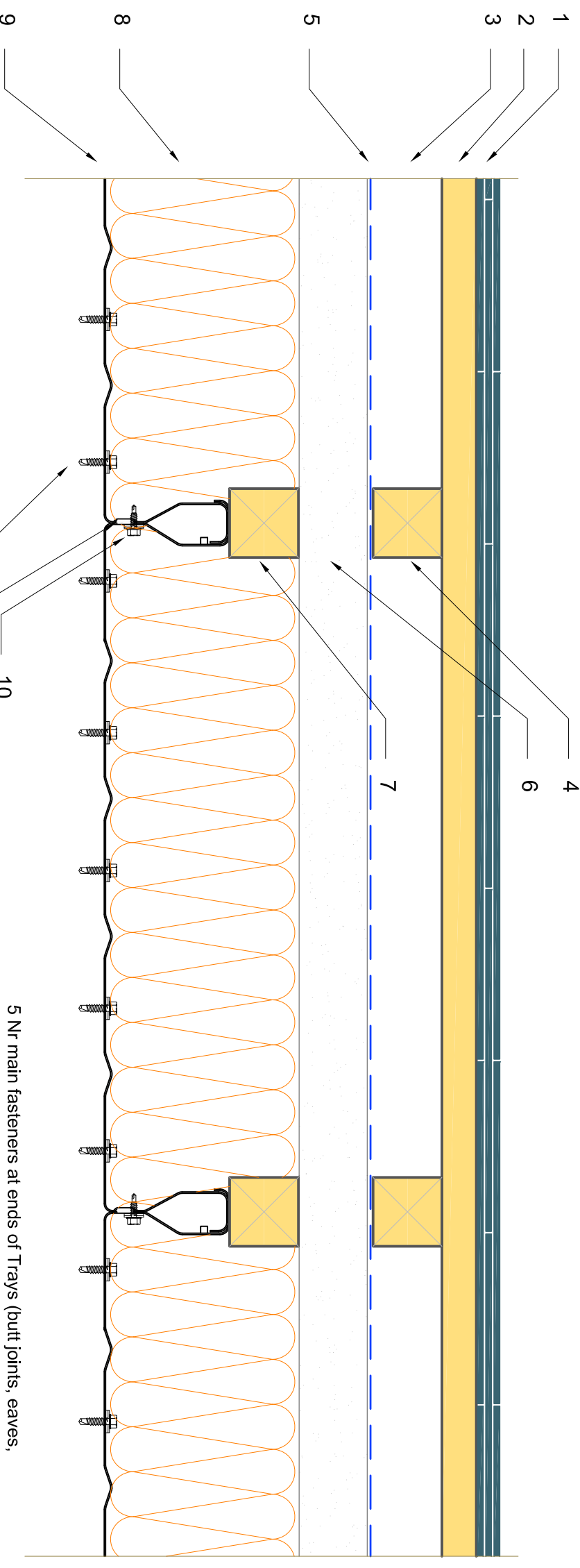

U Value 0.16 W/m²K

3 Nr main fasteners at intermediate positions only

5 Nr main fasteners at ends of Trays (butt joints, eaves, ridge, valley and hip purfins / supports)

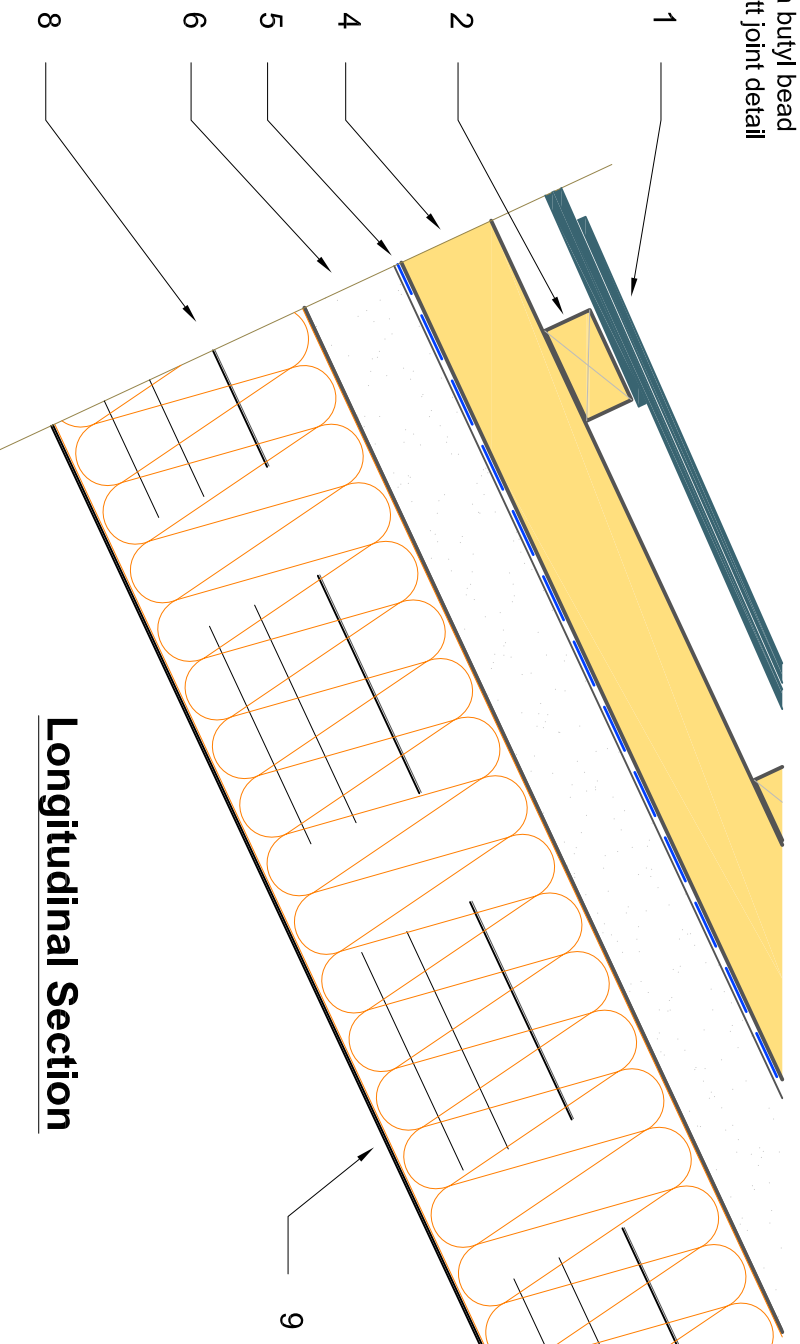
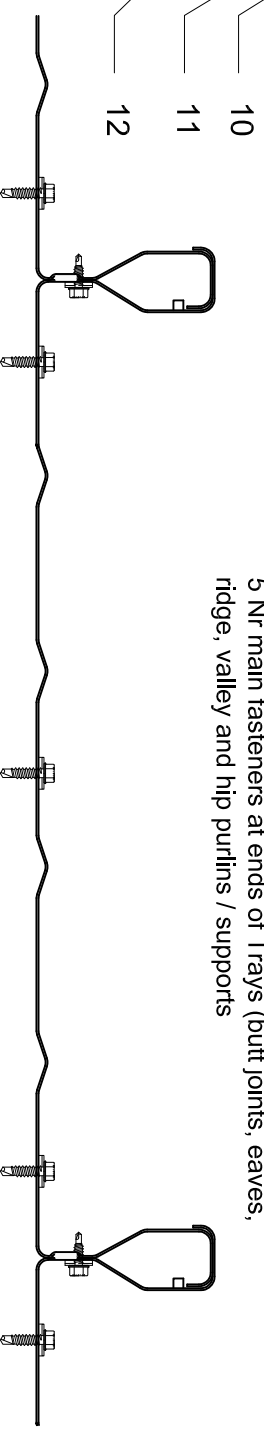

Longitudinal Section

<p>Tileform UK TacTray 90</p>		
<p>Tileform UK Limited Spital Farm Offices Thorpe Mead Banbury Oxon OX16 4RZ</p>		
<p>Tel: 01295 250998 Fax: 01295 271068 email: britnet@tileform.com www.tileform.co.uk</p>		
Drawn	Date	Scale
BTD	20/05/09	Do Not Scale
Revisions		

Tileform UK TacTray 90 - Standard Construction Details for Non Air Permeable Roof Finishes.

U Value 0.16 W/m²K.

DRG No.

TF/TT90/103